



MAIN EXHIBIT HALL (HALLS A AND B)

- 45,500+ sq. ft. of column-free flexible, halls with 30' ceilings
- 788 auditorium seats and lighted aisles

DOCKSIDE EXHIBIT HALL

- Easy accessibility for move-in/out
- 14,000+ sq. ft. of flexible space
- Bay views and boardwalk access

PERFORMING ARTS CENTER

- State-of-the-art sound and lighting equipment
- Box office and concession area
- Spacious dressing rooms
- 16,000 sq. ft with 1,200 seats and a 51' ceiling





BAYFRONT BALLROOM

- 19,126 sq. ft. with 35' ceilings
- Panoramic bay views
- Ballroom-specific climate and audio controls

MEETING ROOMS

- 21 meeting rooms, including 2 executive boardrooms
- Individual climate and audio controls
- Rooms can be combined to accommodate larger groups

DINING OPTIONS

- Bayside promenade connected to an outdoor patio
- Concession area with breakfast and lunch menus
- OC Café Kiosk can be set up in different building areas
- Exclusive catering by Centerplate Catering Company

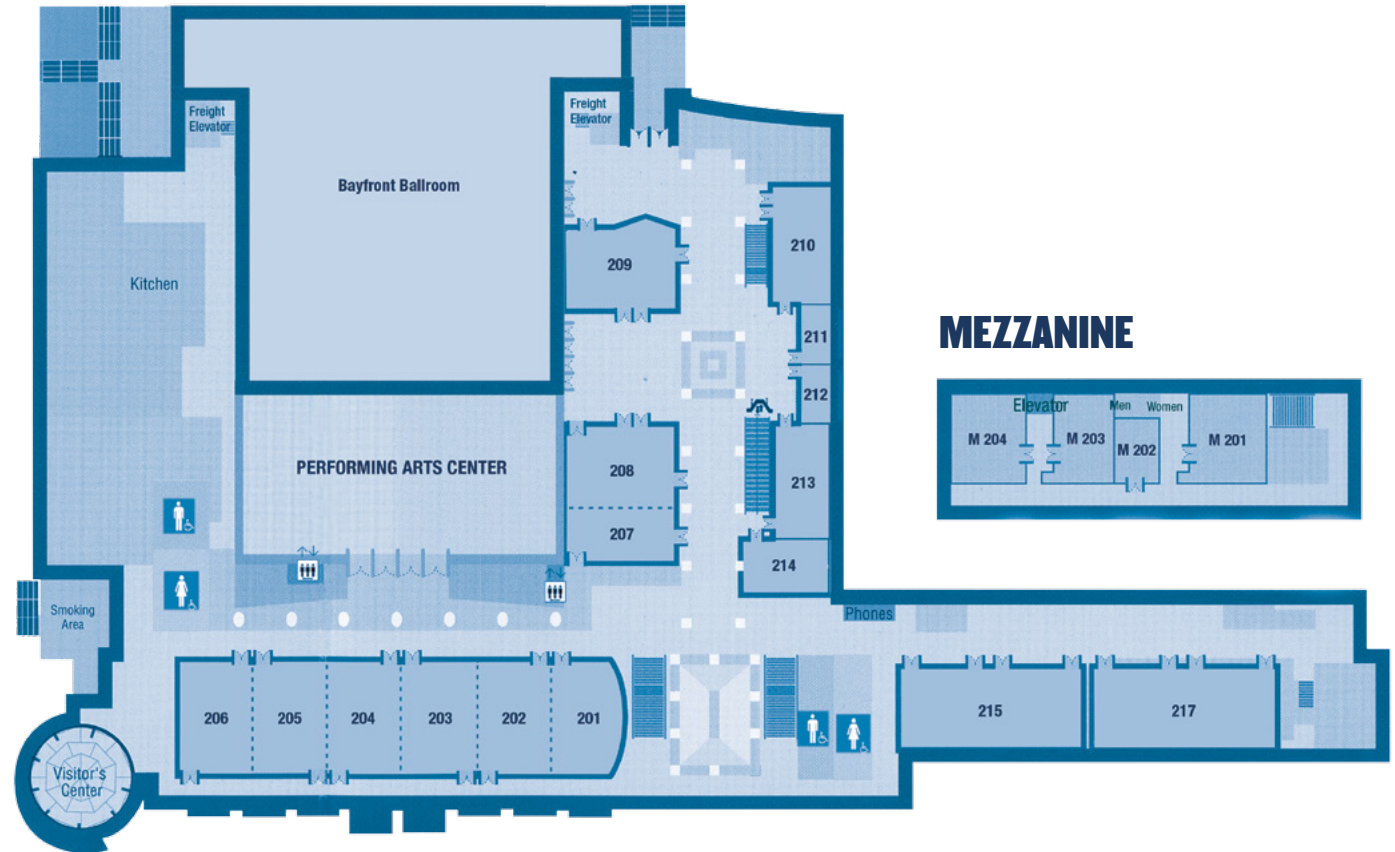



ROOM	SQ. FEET	CEILING	DIMENSIONS	THEATER	CLASSROOM	RECEPTION	BANQUET	EXHIBIT
LEVEL 1								
Exhibit Halls A&B	45,400	30'	227Wx200L	5,000	2,106	4,540	2,520	257 10x10
Exhibit Hall A	25,070	30'	230Wx109L	2,652	1,014	2,500	1,400	151 10x10
Exhibit Hall B	20,700	30'	230Wx90L	1,836	780	2,070	460	119 10x10
Dockside Hall	14,190	15'	-	-	-	1,290	710	73
Performing Arts Center	16,000	51'	-	1,200	-	-	-	-
LEVEL 2								
Bayfront Ballroom	19,126	35'	131Wx146L	1,664	476	1,900	1,070	101 10x10 113 10x8
201	1,702	14'5"	37Wx43L	154	72	170	60	-
202	1,407	14'5"	30.6Wx43L	154	72	140	60	-
203	1,426	14'5"	31Wx43L	154	72	140	60	-
204	1,426	14'5"	31Wx43L	154	72	140	60	-
205	1,426	14'5"	31Wx43L	154	72	140	60	-
206	1,499	14'5"	32.6Wx43L	154	72	150	60	-
201 - 206	8,370	14'5"	-	924	432	1,184	480	32
207	1,152	10'2"	48Wx24L	120	72	165	80	-
208	1,776	10'2"	48Wx37L	198	87	254	110	-
207 - 208	2,914	10'2"	-	255	132	418	150	-
209	1,536	10'2"	48Wx32L	160	86	208	80	-
210	1,078	10'	49Wx22L	140	50	154	50	-
211	300	10'	25Wx12L	20	9	43	16	-
212	300	10'	25Wx12L	20	9	43	16	-
213	1,035	10'	45Wx23L	132	44	148	50	-
214	441	11'	21Wx21L	-	Boardroom 14	-	-	-
215	2,952	14'	82Wx36L	322	195	422	210	-
217	2,844	14'	79Wx36L	322	182	401	180	-
M201	707	7'9"	34.5Wx20.5L	16	Boardroom	16	16	-
M202	195	7'9"	14.5Wx13L	-	-	-	-	-
M203	303	7'9"	-	-	-	-	-	-
M204	518	7'9"	-	30	-	-	-	-